

# PERMANENT SURVEY MONUMENT #2007-25

CITY OF STAUNTON, VIRGINIA

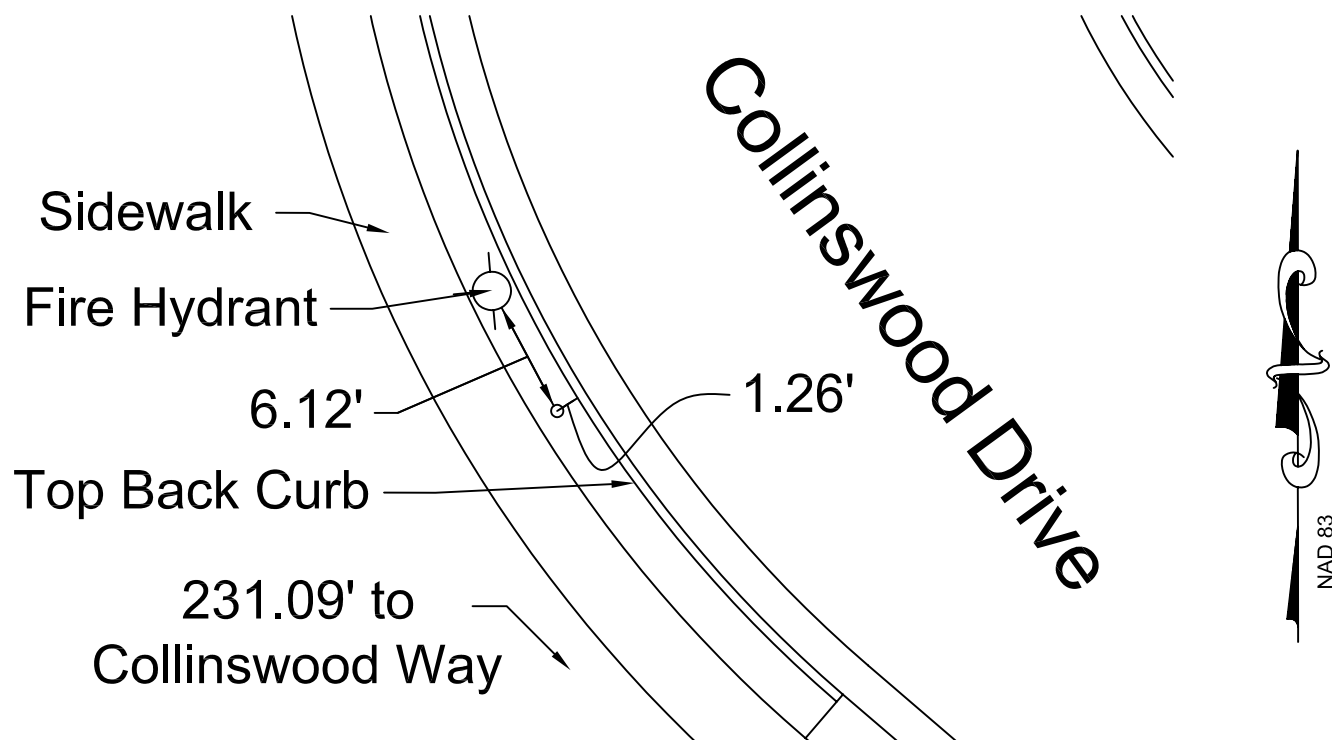

Scale: 1" = 10'

## Location:

N: 6749175.119  
E: 11312108.133

LAT: 38°10'48.17349"N  
LONG: 79°05'39.19798"W

ORTHOMETRIC HEIGHT: 1608.51'

## Notes:

1. This monument is a capped iron rod reading, "City of Staunton Survey Control."
2. The position of this monument is based on "2006 City of Staunton Permanent Control" data provided by the City of Staunton.

## Directions:

Capped iron rod set South East of fire hydrant at North West corner of Collinswood Drive.

# TERRA

Engineering and Land Solutions, PC

415 4th Street, NE  
Charlottesville, Virginia 22902  
ph. 434-244-0600 fax. 434-975-0900