

GPS DATA SHEET

STATION DATA

| | | | |
|---|---|--|--|
| <small>STATION NAME</small> 2008-35 | | <small>MUNICIPALITY</small> CITY OF STAUNTON | |
| <small>ZONE:</small> Virginia North | <small>CONVERGANCE:</small> -00° 21' 48.48311" W | <small>YEAR SET:</small> 2008 | |
| <small>PROJECTION:</small> Lambert | <small>COMBINED FACTOR:</small> 0.999905732 | <small>YEAR RECOVERED:</small> | |
| HORIZONTAL DATA | <small>DATUM:</small> NAD 83/08 | <small>SCALE FACTOR:</small> 0.99997662 | |
| | <small>NORTHING:</small> 6751180.036 | <small>EASTING:</small> 11315527.691 | |
| | <small>LATITUDE:</small> 38° 11' 08.20963" N | <small>LONGITUDE:</small> 079° 04' 56.53205" W | |
| | VERTICAL DATA | | |
| <small>NAVD 88 ELEVATION:</small> 1587.747 ft. | | <small>ELEVATION FACTOR</small> 0.99992911 | |

STATION LOCATION & DESCRIPTION

The station is an iron pin w/aluminum cap set flush with the ground level located at the intersection of Woodrow Wilson Pkwy (Rte. 275) and Shutterlee Mill Road.

Azimuth Mark is an iron pin w/cap located $\pm 124'$ south of the intersection of Shutterlee Mill Rd. and Bull Run Rd. and is 5.9' off the edge of pavement of Shutterlee Mill Rd.

AZ = 210° 00' 38"

Distance = 840.65'

STATION SKETCH

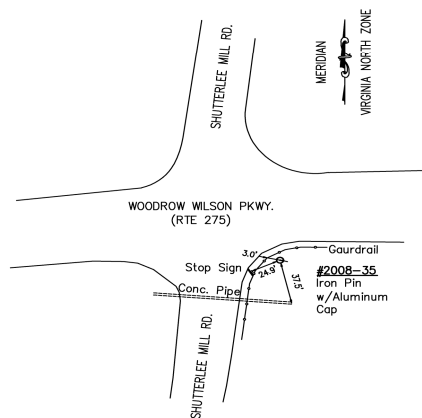

STATION PHOTOGRAPH

