

PERMANENT SURVEY MONUMENT #2009-37 CITY OF STAUNTON, VIRGINIA

LOCATION:

N: 6741146.995
E: 11316663.271

LAT: 38°09'29.09932"N
LONG: 79°04'41.51793"W

ORTHOMETRIC HEIGHT: 1436.122'

DIRECTIONS:

CAPPED IRON ROD SET IN GRASS
SOUTHEAST OF THE FLAGPOLE IN FRONT
OF #600 CHURCHVILLE AVENUE.

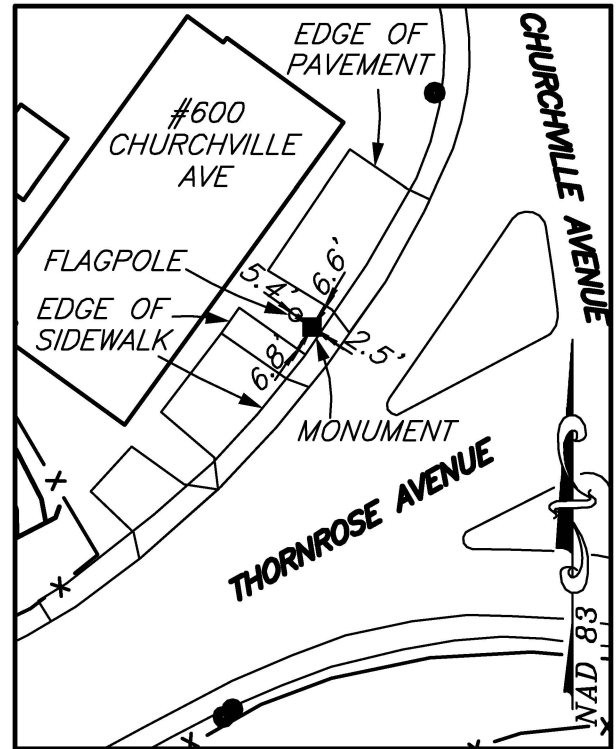

SCALE: 1" = 50'



AZIMUTH MARK:

PK NAIL IN ASPHALT ON THE
NORTHEAST CORNER OF THE
INTERSECTION OF DONAGHE STREET
AND OPIE STREET.

BEARING: N37°52'07"E
DISTANCE: 749.42'

ORTHOMETRIC HEIGHT: 1484.501'

NOTES:

- 1) THIS MONUMENT IS A CAPPED ROD READING "CITY OF STAUNTON SURVEY CONTROL."
- 2) THE POSITION OF THIS MONUMENT IS BASED ON THE 2006 CITY OF STAUNTON PERMANENT CONTROL SURVEY BY WILLIAMS-STACKHOUSE, INC.