

# GPS DATA SHEET

## STATION DATA

<i>STATION NAME</i> <b>2011-51</b>		<i>MUNICIPALITY</i> <b>CITY OF STAUNTON</b>	
<i>ZONE:</i> Virginia North	<i>CONVERGANCE:</i> 00° 20' 24.53709" W	<i>YEAR SET:</i> 2011	
<i>PROJECTION:</i> Lambert	<i>COMBINED FACTOR:</i> 0.999922391	<i>YEAR RECOVERED:</i>	
<b>HORIZONTAL DATA</b>	<i>DATUM:</i> NAD 83/93	<i>SCALE FACTOR:</i> 0.99998125	
	<i>NORTHING:</i> 6,738,675.845 ft.	<i>EASTING:</i> 11,326,192.593 ft.	
	<i>LATITUDE:</i> 38° 09' 05.24709" N	<i>LONGITUDE:</i> 079° 02' 42.02858" W	
	<i>NAVD 88 ELEVATION:</i> 1336.444 ft.		<i>ELEVATION FACTOR</i> 0.99994114

## STATION LOCATION & DESCRIPTION

The station is an aluminum disk on a threaded rod set flush with the ground level in the grass shoulder along New Hope Road. The station is  $\pm$  0.57 miles northeast of the intersection of Statler Blvd. and New Hope Road.

### STATION SKETCH

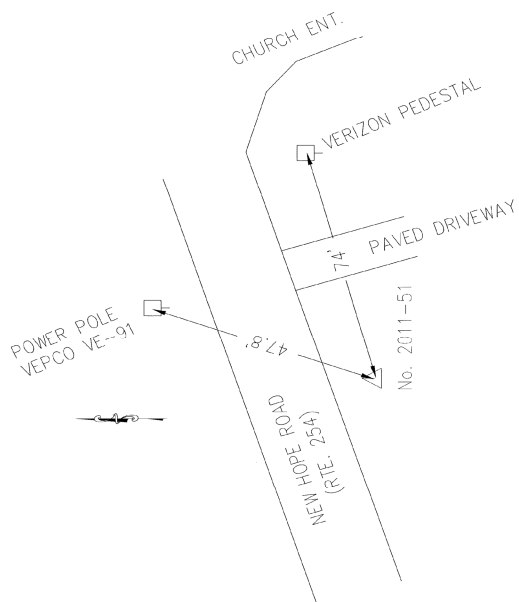

### STATION PHOTOGRAPH

