

# GPS DATA SHEET

## STATION DATA

<i>STATION NAME</i> <b>2011-52</b>		<i>MUNICIPALITY</i> <b>CITY OF STAUNTON</b>	
<i>ZONE:</i> Virginia North	<i>CONVERGANCE:</i> 00° 20' 00.50465" W	<i>YEAR SET:</i> 2011	
<i>PROJECTION:</i> Lambert	<i>COMBINED FACTOR:</i> 0.999921811	<i>YEAR RECOVERED:</i>	
<b>HORIZONTAL DATA</b>	<i>DATUM:</i> NAD 83/93	<i>SCALE FACTOR:</i> 0.99998161	
	<i>NORTHING:</i> 6,737,741.045 ft.	<i>EASTING:</i> 11,329,263.047 ft.	
	<i>LATITUDE:</i> 38° 08' 56.18456" N	<i>LONGITUDE:</i> 079° 02' 03.52233" W	
	<i>VERTICAL DATA</i>		
<i>NAVD 88 ELEVATION:</i> 1356.094 ft.		<i>ELEVATION FACTOR</i> 0.99994020	

## STATION LOCATION & DESCRIPTION

The station is an aluminum disk on a threaded rod set flush with the ground level in the grass shoulder along New Hope Road. The station is  $\pm$  0.34 miles west of the intersection of New Hope Road and National Ave.

### STATION SKETCH

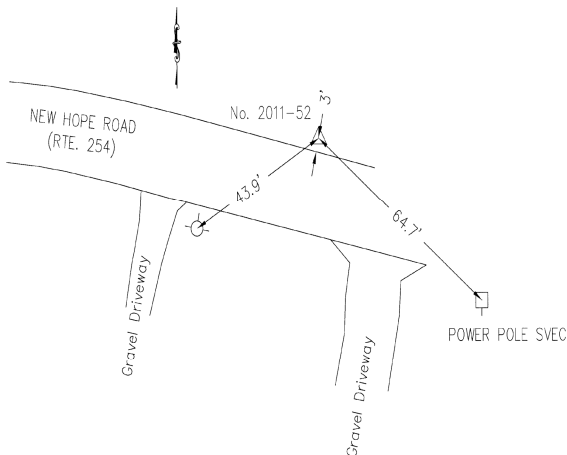

### STATION PHOTOGRAPH

